



The Canadian Cottage Series



SHELTER
HOME SYSTEMS

The Canadian Cottage Series



“The Riverview”
14' x 50', 616 sq. ft., 2FL-1B

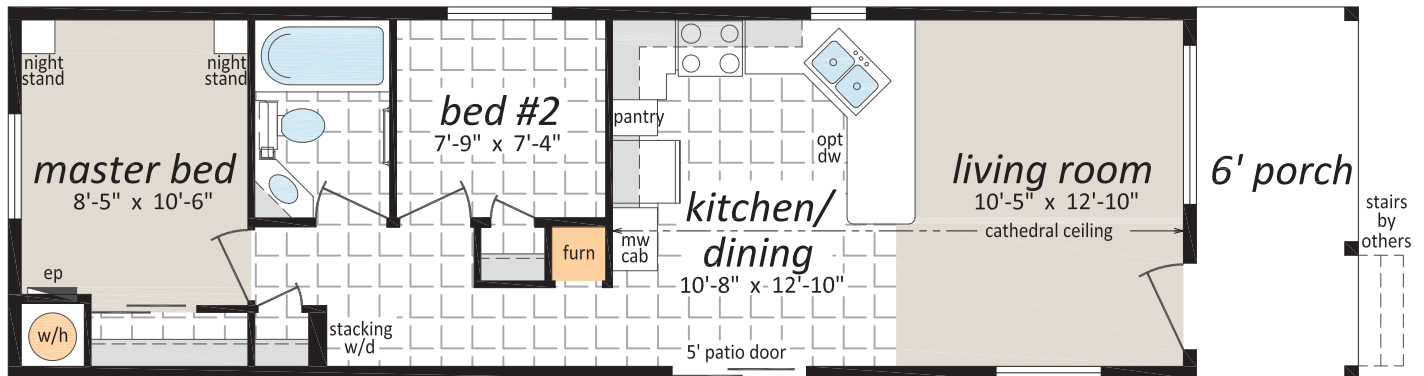

Popular Optional Features

- Exterior Third Gables
- Garden Door
- Energy Efficient Low-E Windows
- Vinyl Shutters
- Exterior Door with Half Round or 9 Lite Insert
- Skylights
- Turbine Vents
- High Snow Load
- Laminate Flooring
- Classique White Raised Panel Passage Doors
- Utility Room Door with Grill
- Ceiling Fan with Lights
- Deluxe Drapery Package #2
- Pewter Drapery Package
- 40 Gallon Electric Water Heater
- Electric Furnace
- Air Conditioner-Ready Furnace
- Extra Telephone/Cable Boxes
- Stacking Washer and Dryer
- 200 Amp Service Panel
- Single Lever Faucet with Vegetable Sprayer
- Self Cleaning Oven
- Built-In Dishwasher
- Combination Microwave/Range Hood
- Jetted One Piece Tub & Shower
- Handicap Toilet

The Canadian Cottage Series



“The Fairview”
 16' x 50', 704 sq. ft., 2FL-1B

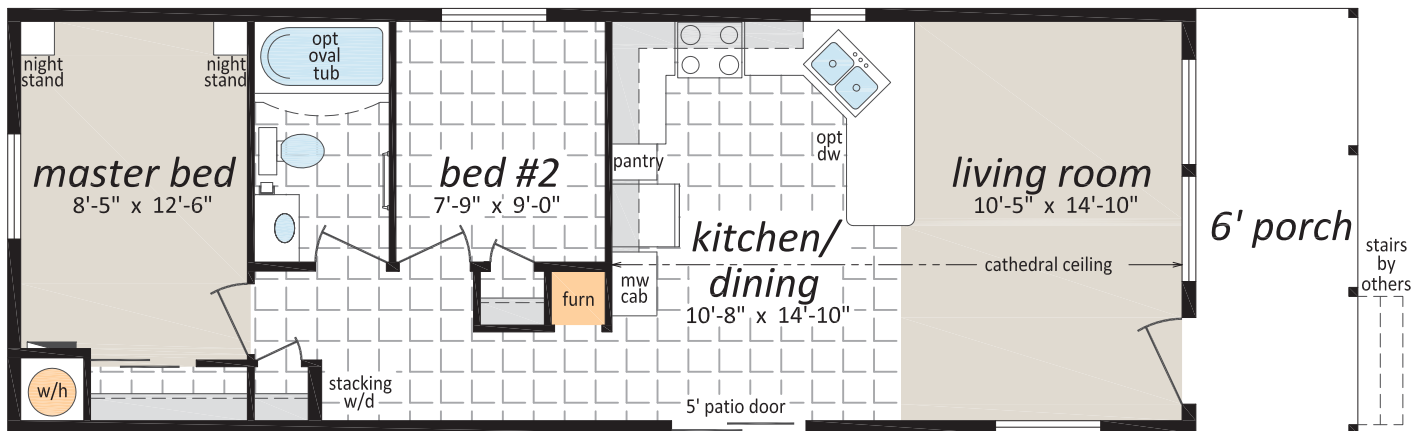

The Canadian Cottage Series



Standards and Specifications

Exterior

- ☆ 30 Year Architectural Fiberglass Shingles
- ☆ Engineered Roof Trusses
- ☆ 12" Residential Eaves on 3 Sides
- ☆ Low Maintenance Vinyl Siding
- ☆ 8' Walls
- ☆ 2 x 6 @ 24" o.c. Outside Walls
- ☆ 3/8" OSB Sheathing on Inside and Outside of Ext. Walls
- ☆ 8" or 12" Tubular Laminated Steel Frame (*depends on length*)
- ☆ 2 x 8 Floor Joists (*14' wide*)
- ☆ 2 x 10 Floor Joists (*16' wide*)
- ☆ Weatherproof Exterior GFI Receptacle
- ☆ Frost Free Tap c/w Check Valve
- ☆ Coach Lights at all Exterior Doors
- ☆ T&G OSB Floor Decking; Glued and Screwed
- ☆ Insulation: R-40 Ceiling, R-20 Wall, R-26 Floor
- ☆ 6 MIL Poly Vapour Barrier in Ceiling and Sidewalls
- ☆ Spraytexted 1/2" Gyproc Ceilings
- ☆ Cathedral Ceiling in Kitchen, Dining Room & Living Room
- ☆ Smart Trim Around Windows
- ☆ 36" Insulated No Light Front Door c/w Peephole
- ☆ 5' Patio Door at Dining Room
- ☆ Aluminum Storm Door at Front Entry
- ☆ White PVC "Low E" w/Screens
- ☆ 4 Pot Lights in Porch Area
- ☆ Vinyl Shakes At Front Gable
- ☆ Painted Beams At Hitch End
- ☆ Coloured Fascia/Corners and Columns
- ☆ 6' Front Porch w/Aluminum Railing

Bathroom

- ☆ GFI Receptacles
- ☆ Dehumidistat on Main Bath Fan
- ☆ One Piece Wall Tub/Shower in all Bathrooms
- ☆ Single Lever Faucet
- ☆ White Bath Fixtures
- ☆ Shower Rod and Curtain Liner in all Bathrooms
- ☆ Pewter Towel Bar and Paper Holder
- ☆ 3" White Subway Tile Backsplash

Interior

- ☆ 3" White Subway Kitchen Tile Backsplash
- ☆ PVC Wrap Cabinet Doors
- ☆ Modular Cabinets
- ☆ 2" Blinds T/O
- ☆ Wire Closet Shelving
- ☆ 100% Polyurethane Carpet in Living Room & Bedrooms
- ☆ No Wax Vinyl Flooring
- ☆ Pewter Interior Door Hardware T/O
- ☆ Pre-finished White Embossed Interior Doors
- ☆ Ceiling Trim: 1011 Profile
- ☆ Baseboards: 1011 Profile
- ☆ Window/Door Trim: 1011 Profile
- ☆ Cabinet Crown Moulding: 510 Profile
- ☆ Closets: Battens Throughout

Kitchen

- ☆ 18 CU. FT. Two Door Fridge - Top Freezer - White
- ☆ 30" Electric Range - White
- ☆ Dishwasher - White
- ☆ Double Stainless Steel Sink
- ☆ Single Lever Faucet
- ☆ Two Speed Range Hood Vented to Exterior
- ☆ Roller Drawer Hardware

Utilities

- ☆ 40 GI Natural Gas Water Heater
- ☆ Natural Gas High Efficiency Furnace w/Electronic Ignition
- ☆ 100 Amp Electric Service Panel
- ☆ Electric Conduit Through Floor
- ☆ Light Bulb Package
- ☆ Smoke/CO Alarms w/Battery Back Up In Hallways
- ☆ Smoke Alarms In All Bedrooms
- ☆ Plumbed and Wired For Stacking Washer/Dryer
- ☆ Copper Wiring Throughout

Authorized Retailer: